

↖ CURRENT

MODEL P - SMART PIZZA OVEN

25553203

25553205



SAFETY SYMBOLS

The symbols and boxes shown below explain what each heading means. Read and follow all of the messages found throughout the manual.



CAUTION

CAUTION: Indicates a potentially hazardous situation or unsafe practice which, if not avoided, may result in minor or moderate injury.



WARNING

WARNING: Indicates a potentially hazardous situation which, if not avoided, could result in death or serious injury.



DANGER

DANGER: Indicates an imminently hazardous situation which, if not avoided, will result in death or serious injury.

FOR INDOOR/OUTDOOR USE

Keep this manual for future reference.

This instruction manual contains important information necessary for the safe use of the appliance.



WARNING

Failure to follow all manufacturer's instructions could result in serious personal injury and/or property damage.

- Read and follow all the information and safeguards in this product guide before attempting to assemble or operate this pizza oven.

IMPORTANT SAFEGUARDS

Follow these **IMPORTANT SAFEGUARDS** for Safe Use of Your appliance and to Avoid Serious Injury:

When using electrical appliances, basic safety precautions should always be followed including the following:

READ ALL INSTRUCTIONS

1. Do not touch hot surfaces. Use handles or knobs provided for operation.
 - a. This appliance will be hot during and after use. Use insulated oven mitts or gloves and long-handled utensils for protection from hot surfaces.
2. To protect against electrical shock, do not immerse cord, plugs, or any portion of the appliance in water or any other liquid.
3. Store product indoors when not in use – out of the reach of children.
4. Close supervision is necessary when appliance is used near children.
5. Keep children and pets away from the appliance at all times.
6. Unplug from outlet when not in use and before moving or cleaning. Allow to cool before putting on or taking off parts.
7. Do not operate any appliance with a damaged cord or plug or after the appliance malfunctions or has been damaged in any manner.
8. Replace damaged part(s) only with Current Backyard replacement parts. Do not attempt to repair damaged parts.
9. The use of accessory attachments not recommended by the appliance manufacturer may cause injuries.
10. Do not let cord touch hot surfaces. Do not let cord hang over edge of tabletop or other items where it can be pulled by children or tripped over.
11. Do not place on or near a hot gas or electric burner, or in a heated oven.
12. Do not move the appliance when in use.
13. Extreme caution must be used when moving an appliance containing hot oil or other hot liquids.
14. Do not use appliance for other than intended use. This appliance is not intended for and should never be used as a heater.
15. Do not use for commercial cooking.
16. The use of alcohol, prescription or non-prescription drugs may impair the consumer's ability to properly assemble or safely operate the appliance.
17. When cooking, the appliance must be on a level, stable surface in an area clear of combustible material. Do not use or store gasoline, kerosene or other flammable liquids within 20 feet of this appliance when in use.
18. Do not leave appliance unattended when ON.
19. To prevent appliance from being splashed or falling into water, do not use within 10 feet of a pool, pond or other body of water.
20. If using outdoors, always unplug cord from outlet when done cooking.
21. To disconnect, turn any control to "off", then remove plug from wall outlet.

USE AND CARE

22. Oversize foods or metal utensils must not be inserted in an oven as they may create a fire or risk of electric shock.
23. A fire may occur if the oven is covered or touching flammable material, including curtains, draperies, walls, and the like, when in operation. Do not store any item on top of the appliance when in operation.
24. Extreme caution should be exercised when using containers constructed of other than metal or glass.
25. Do not store any materials, other than manufacturers recommended accessories, in this oven when not in use.
26. Do not place any of the following materials in the oven: paper, cardboard, plastic, and the like.
27. Do not cover any part of the oven with metal foil. This will cause overheating of the oven.
28. Do not clean this product with a water spray or the like.



DANGER

In case of fire, unplug oven from outlet and allow fire to burn out. Do not use water to put out a fire in this or any electrical appliance.

Do not operate in the rain. Keep electric plugs off ground and dry. Store pizza oven in weather protected area or under accessory cover when not in use.

Electrical Requirements and Safety



DANGER

Use only on properly grounded outlet. Never remove grounding plug or use with an adapter to two prongs. Do not use this appliance if the circuit does not have GFI protection.

Use only with GFI (Ground Fault Interrupter) protected circuit. We recommend using a 20-amp breaker and 20-amp GFCI for best performance. Running it on a lower current outlet/circuit breaker may cause the circuit to trip. **IF OUTLET IS NOT 15-AMP OR HIGHER, PLEASE HAVE AN ELECTRICIAN REPLACE THE OUTLET.**

Since 1971, the National Electric Code (NEC) has required Ground Fault Interrupter devices on all outdoor circuits. If your residence was built before 1971, check with a qualified electrician to determine if a Ground Fault Interrupter protector exists.

Since 1996, the National Electric Code (NEC) has required Ground Fault Interrupter devices on all kitchen countertop receptacles. If your residence was built before 1996, or you are using an outlet not located above a kitchen countertop, check with a qualified electrician to determine if a Ground Fault Interrupter protector exists.

To prevent power loss:

- To prevent household circuit breakers or GFI outlets from tripping, keep electric controller dry and do not use other electrical products on the same circuit.
- Unplug any other electrical devices, like patio lights, powered by the outlet/circuit breaker before plugging in your oven.

If power is lost during use:

- Identify and unplug any other electrical devices that lost power at the same time and reset the breaker.
- If your circuit breaker continues to trip during use, consult a qualified electrician.
- Try using a different electrical outlet, if available. Follow the guidelines in "Extension Cord Use and Safety."

Extension Cord Use and Safety

For best oven performance, use of extension cord is not recommended. If you must use an extension cord, for your safety, care shall be exercised in the use of extension cord:

- Use only outdoor type with 3 prong grounding plug, rated for 15 amperes or more, approved by UL, marked with a W and a tag stating "Suitable for Use with Outdoor Appliance".
- The cord should be arranged so that it will not drape over the countertop or tabletop where it can be pulled on by children or tripped over unintentionally.
- The connection to an extension cord should be kept dry and off the ground.
- Use the shortest length extension cord required. Do not connect 2 or more extension cords together. A 12 or 14 gauge extension cord of 50 ft. or less is acceptable.



WARNING

Do not use 16 or 18 gauge extension cords. Damage to household wiring and/or fire could result.

USE AND CARE

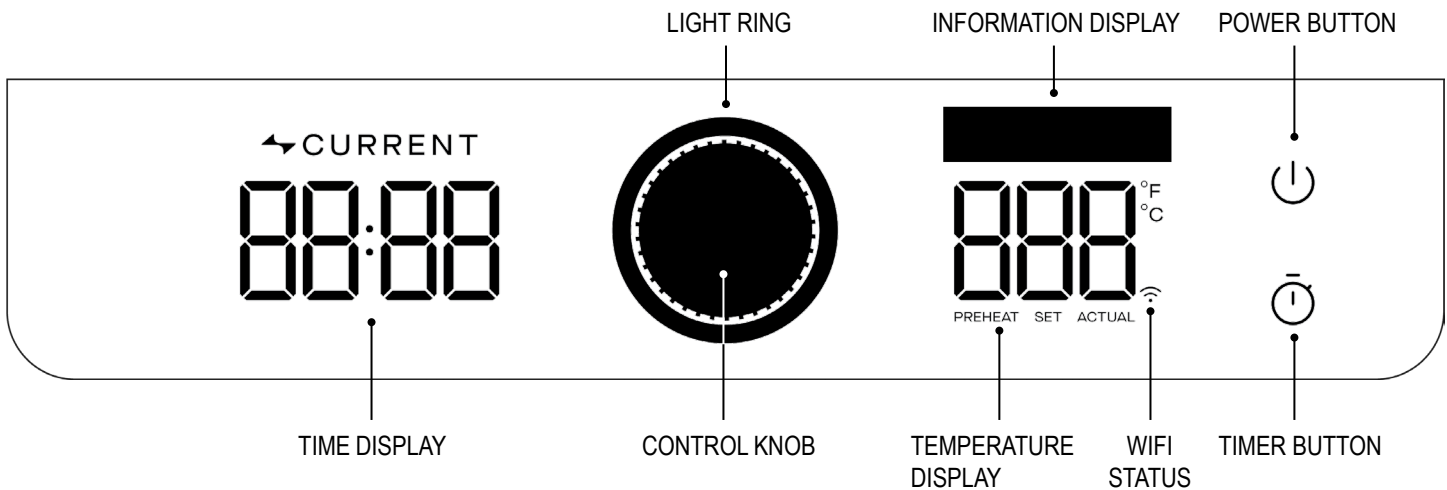

CONTROLLER FUNCTIONALITY

POWER BUTTON – Quick press to turn appliance on. Press and hold to turn off.

CONTROL KNOB – Rotate control knob to select cook setting, or to adjust time or temperature. Press to confirm selection.

TIMER BUTTON – After the cook has been selected and the preheat is complete, press the time button then rotate the knob to adjust the length of the cook.

INFORMATION DISPLAY – Displays the status of the oven, or what is needed next for the cook.

TEMPERATURE DISPLAY – Alternates between the set (or target) temperature and the actual temperature during preheat. After selecting the cook mode and beginning the preheat process, the control knob can be rotated to adjust the set temperature up or down as desired.

TEMPERATURE UNITS – A quick press of the power button and timer button while the unit is in standby mode will toggle the temperature units.

TIME DISPLAY – Countdown timer for individual cooks.

LIGHT RING – Visual indicator of oven status. Blue indicates standby. Red indicates cook mode is active. Orange indicates an error.

ERROR CODES – an orange light ring and a displayed code of E01, E02, E03, or E04 indicate a temperature sensor fault. Please unplug unit, allow to cool, and then repeat cook procedure. If error persists, please contact customer service at 1-866-CURRENT.

Before first use of oven:

Remove all packaging and sale labels from the oven. Do not use sharp tools to remove stickers.



WARNING

Your oven should be placed four inches away from walls or any objects on the countertop. DO NOT PLACE OBJECTS ON TOP OF THE OVEN OR AGAINST SIDE WALLS WHEN OVEN IS IN USE. THE EXTERIOR WALLS, DOOR, AND WINDOW GET VERY HOT.

Place baking rack in oven and insert pizza stone as shown.

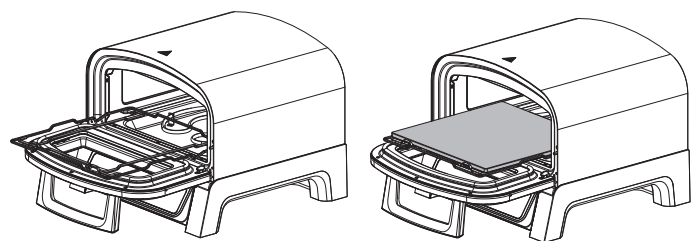

Turn oven on and preheat to the Neapolitan cook setting. This will remove any residue inside the cooking chamber.



USE AND CARE

COOKING

DO NOT OPERATE pizza oven without pizza stone or sizzle plate (sold separately) in place.

PIZZA (Neapolitan, New York, Thin Crust, Frozen)

1. Ensure food particles and cheese or any other residue has been removed from the stone and that the stone is completely dry.
2. Place stone in baking rack.
3. Plug power cord into a properly grounded, GFI protected outlet. If extension cord must be used, refer to “Extension Cord Use and Safety” on page 3.
4. Press power button to turn the oven on. The light ring will turn blue indicating the controller is ready for use.
5. Rotate control knob to select pizza type. Press knob to confirm and start preheat.
 - a. During preheat, you may adjust your temperature up or down as needed. Rotate the knob to the desired temperature and press to confirm.
6. Sections of the light ring will pulse red and gradually illuminate to show the progress of the preheat cycle. Once the SET temperature is reached, the light ring will be solid red. During the preheat cycle, the temperature display will alternate between SET and ACTUAL temperature until SET temperature is reached.

BROIL

1. Place sizzle plate (sold separately) on pizza stone.
2. Plug power cord into a properly grounded, GFI protected outlet. If extension cord must be used, refer to “Extension Cord Use and Safety” on page 3.
3. Press power button to turn the oven on. The light ring will turn blue indicating the controller is ready for use.
4. Rotate control knob to select the BROIL setting. Press knob to confirm and start preheat.
 - a. During preheat, you may adjust your temperature up or down as needed. Rotate the knob to the desired temperature and press to confirm.
5. Sections of the light ring will pulse red and gradually illuminate to show the progress of the preheat cycle. Once the SET temperature is reached, the light ring will be solid red. During the preheat cycle, the temperature display will alternate between SET and ACTUAL temperature until SET temperature is reached.

If you have an appliance problem see the “Troubleshooting Section”.



WARNING

Use extreme caution when removing sizzle plates (sold separately) or disposing of hot grease.

Oven Auto Shutoff

- If no cooking profile is selected, the oven will automatically turn off after 15 minutes of inactivity.
- If a cooking profile has been selected and the preheat temperature is reached, a warning will appear after 15 minutes of no user interaction.
- After the warning, the oven will turn off completely after an additional 5 minutes, for a total of 20 minutes from the initial 15-minute inactivity period.

USE AND CARE

CLEANING



DANGER

To avoid the possibility of serious burns, be sure pizza oven is cool before cleaning the pizza stone or any part of the appliance. Allow oven and stone to cool completely before moving, cleaning or storing.

It is recommended to clean your pizza stone after each use.

To clean the stone:

- Allow stone to cool completely before removing from the oven.
- Use nylon bristle brush to remove food particles.
- Using a plastic spatula or bench scraper, scrape off any baked on cheese or food residue
- Use a damp cloth to wipe all remaining residue from the stone.
- Air dry the stone prior to returning it to the oven.



CAUTION

If a bristle brush is used to clean the stone, ensure no loose bristles remain on the stone prior to cooking.

- DO NOT PLACE STONE IN DISHWASHER.
- DO NOT USE SOAP ON STONE.
- Do not soak or submerge stone in water or other liquid. The stone's pores will hold the liquid and will affect your next cook, and could result in the stone cracking.
- Do not use sharp or pointed tools to clean the pizza stone or any part of the oven.
- Do not use abrasive oven cleaners, steel wool or metal brushes to clean the pizza stone or oven body. They will cause damage.

To clean the controller display:

- Wipe controller display with a soft, dry cloth.

To clean the window:

- Use damp non-metallic, non-scratch scouring pads to clean window.

General Cleaning

- Use damp, soapy cloth to clean outside surfaces and inner walls of the unit.
- Use damp non-metallic, non-scratch scouring pads to clean window.
- DO NOT clean heating tubes at top of oven.
- Do not clean with metal scouring pads. Pieces can break off the pad and touch electrical parts, creating a risk of electric shock. (*UL1026 for Broiler-Ovens*)

SAVE THESE INSTRUCTIONS

STORING

- Clean pizza stone or sizzle plates (sold separately).
- Store oven indoors, or in weather protected area or under accessory cover when not in use.
- Always unplug your oven prior to storage.

Replacement Parts

To order additional parts or accessories, please visit currentbackyard.com or contact our Customer Service team at 1-866-CURRENT. For the fastest service, please register your product using one of the methods below prior to calling.



TROUBLESHOOTING

Problem	Possible Cause	Prevention/Solution
Oven does not power on	• Oven is not plugged in.	• If the CURRENT logo and power button are not illuminated, verify the unit is plugged in.
	• No power to the outlet.	• If the CURRENT logo and power button are not illuminated, plug another device into the outlet to determine if power is available. If no power, reset GFI or breaker. If still no power, consult a local electrician.
	• Controller error.	• Contact customer service at 1-866-CURRENT.
Oven does not heat, or takes too long to heat up.	• Door left open.	• When the door is left open, the heating elements do not function. Close door and allow the oven to complete the preheat cycle.
	• Cold weather affects the heat up time.	• If cooking outside during cold weather, heat up times will be several minutes longer than usual.
	• Heating element or temperature sensor defective.	• Contact customer service at 1-866-CURRENT.
Oven turns off on its own.	• Auto-shutoff time reached.	<ul style="list-style-type: none"> • If no cooking profile is selected, the oven will automatically turn off after 15 minutes of inactivity. • If a cooking profile has been selected and the preheat temperature is reached, a warning will appear after 15 minutes of no user interaction. • After the warning, the oven will turn off completely after an additional 5 minutes, for a total of 20 minutes from the initial 15-minute inactivity period.
Water found below oven after cooking	• Moisture from cooking chamber condenses and leaks out.	<ul style="list-style-type: none"> • It is natural to have some water below the unit when cooking foods with high moisture content. • If pizza stone has been rinsed or submerged in water, excess water will evaporate and then condense around oven base. Follow instructions in product guide for cleaning with limited water contact.



TROUBLESHOOTING

Problem	Possible Cause	Prevention/Solution
Product won't connect to Bluetooth	<ul style="list-style-type: none"> Product is too far away from phone 	<ul style="list-style-type: none"> Complete pairing process with device within 5 ft of phone.
	<ul style="list-style-type: none"> Phone Bluetooth turned off or on Airplane Mode 	<ul style="list-style-type: none"> In your mobile device settings, make sure Bluetooth is turned on and airplane mode is disabled. For Android devices, make sure that location services are turned on and that the application is permitted to use location services. This will enable Bluetooth to be used in the application. For iPhone devices, check that Bluetooth is enabled for the application in the operating system settings.
	<ul style="list-style-type: none"> Product is already paired to another phone 	<ul style="list-style-type: none"> Use the original mobile device paired to the product or reset the grill's connections. If resetting the grill connection, first remove the product from the mobile device Bluetooth settings. Alternatively, turn off bluetooth on the previous mobile device while performing the pairing process. To reset grill connection, press and hold the control knob for 10 seconds. A beep will sound indicating reset is complete. Now go through the pairing process for Bluetooth on the device.
	<ul style="list-style-type: none"> Product is already paired to the same phone 	<ul style="list-style-type: none"> Turn the product off and close the application. Turn product back on and re-open the application. If product is still not connected by Bluetooth, remove the product from the mobile phone operating system Bluetooth device settings. On the oven, press and hold the control knob until it beeps to clear the oven's Bluetooth settings and restart the pairing process.
Product won't connect to WiFi	<ul style="list-style-type: none"> Incorrect router password 	<ul style="list-style-type: none"> Check password and try wifi connection process again.
	<ul style="list-style-type: none"> No internet 	<ul style="list-style-type: none"> Verify internet access on other devices. If other devices have internet: Unplug oven for 30 seconds and plug back in. Check for connection. Unplug router for 30 seconds and plug back in. Check for connection. Perform WiFi setup in the application again - if the WiFi network does not appear in the scan list, the product may be too far from the router.
	<ul style="list-style-type: none"> Router is too far away from oven 	<ul style="list-style-type: none"> Perform WiFi setup in the application again - if the WiFi network does not appear in the scan list, the product may be too far from the router. With a mobile device in the area where the oven is located, check that there is internet access.
	<ul style="list-style-type: none"> Obstacles between router and oven 	<ul style="list-style-type: none"> Position oven such that the number of walls and objects between the oven and the router is minimized.
	<ul style="list-style-type: none"> No 2.4GHz wifi 	<ul style="list-style-type: none"> Oven only supports 2.4G WiFi networks. An alternate router is required.



LIMITED WARRANTY

This warranty only applies to units purchased from an authorized retailer. Manufacturer warrants to the original consumer-purchaser only that this product shall be free from defects in workmanship and materials after correct assembly and under normal and reasonable home use for the periods indicated below beginning on the date of purchase*. The manufacturer reserves the right to require that defective parts be returned, postage and or freight pre-paid by the consumer for review and examination.

SCOPE OF COVERAGE	PERIOD OF COVERAGE <i>with</i> Registration	PERIOD OF COVERAGE <i>WITHOUT</i> Registration	TYPE OF FAILURE COVERAGE
Stainless Steel Cooking Chamber Liner	10 years from date of purchase*	5 years from date of purchase*	PERFORATION, MANUFACTURING, AND MATERIAL DEFECTS ONLY
Electronics and Pizza Stone	2 year from date of purchase*	1 year from date of purchase*	
All Other Parts	5 years from date of purchase*	3 years from date of purchase*	

*Note: A dated sales receipt WILL be required for warranty service.

The original consumer-purchaser will be responsible for all shipping charges for parts replaced under the terms of this limited warranty.

This limited warranty is applicable in the United States and Canada only, is only available to the original owner of the product and is not transferable.

Manufacturer requires proof of your date of purchase. Therefore, you should retain your sales slip or invoice. Registering your product is not a substitute for proof of purchase and the manufacturer is not responsible for or required to retain proof of purchase records. This limited warranty applies to the functionality of the product ONLY and does not cover cosmetic issues such as scratches, dents, corruptions or discoloring by heat, abrasive and chemical cleaners or any tools used in the assembly or installation of the appliance, surface rust, or the discoloration of stainless steel surfaces. Paint is not warranted and will require touch up. RUST is not considered a manufacturing or materials defect.

This limited warranty will not reimburse you for the cost of any inconvenience, food, personal injury or property damage.

ITEMS MANUFACTURER WILL NOT PAY FOR:

1. Shipping cost, standard or expedited, for warranty and replacement parts.
2. Service calls to your home.
3. Repairs when your product is used for other than normal, single-family household or residential use.
4. Damage, failures, or operating difficulties resulting from accident, alteration, careless handling, misuse, abuse, fire, flood, acts of God, improper installation or maintenance, installation not in accordance with electrical or plumbing codes, or use of products not approved by the manufacturer.
5. Any food loss due to product failures or operating difficulties.
6. Replacement parts or repair labor costs for units operated outside the United States or Canada.
7. Pickup and delivery of your product.
8. Repairs to parts or systems resulting from unauthorized modifications made to the product.
9. The removal and/or reinstallation of your product.

DISCLAIMER OF IMPLIED WARRANTIES and LIMITATION OF REMEDIES

Repair or replacement of defective parts is your exclusive remedy under the terms of this limited warranty. In the event of parts availability issues, the manufacturer reserves the right to substitute like or similar parts that are equally functional. Manufacturer will not be responsible for any consequential or incidental damages arising from the breach of either this limited warranty or any applicable implied warranty, or for failure or damage resulting from acts of God, improper care and maintenance, grease fire, accident, alteration, replacement of parts by anyone other than Manufacturer, misuse, transportation, commercial use, abuse, hostile environments (inclement weather, acts of nature, animal tampering), improper installation or installation not in accordance with local codes or printed manufacturer instructions.

THIS LIMITED WARRANTY IS THE SOLE EXPRESS WARRANTY GIVEN BY THE MANUFACTURER. NO PRODUCT PERFORMANCE SPECIFICATION OR DESCRIPTION WHEREVER APPEARING IS WARRANTED BY MANUFACTURER EXCEPT TO THE EXTENT SET FORTH IN THIS LIMITED WARRANTY. ANY IMPLIED WARRANTY PROTECTION ARISING UNDER THE LAWS OF ANY STATE, INCLUDING IMPLIED WARRANTY OF MERCHANTABILITY OR FITNESS FOR A PARTICULAR PURPOSE OR USE, IS HEREBY LIMITED IN DURATION TO THE DURATION OF THIS LIMITED WARRANTY.

Neither dealers nor the retail establishment selling this product has any authority to make any additional warranties or to promise remedies in addition to or inconsistent with those stated above. Manufacturer's maximum liability, in any event, shall not exceed the purchase price of the product paid by the original consumer. NOTE: Some states do not allow an exclusion or limitation of incidental or consequential damages, so some of the above limitations or exclusions may not apply to you. This limited warranty gives you specific legal rights as set forth herein. You may also have other rights which vary from state to state. In the state of California only, if refinishing or replacement of the product is not commercially practicable, the retailer selling this product or the Manufacturer will refund the purchase price paid for the product, less the amount directly attributable to use by the original consumer-purchaser prior to discovery of the nonconformity. In addition, in the state of California only, you may take the product to the retail establishment selling this product in order to obtain performance under this limited warranty. If you wish to obtain performance of any obligation under this limited warranty, you should write to:

Consumer Relations

P. O. Box 1240

Columbus, GA 31902-1240

Consumer returns will not be accepted unless a valid Return Authorization is first acquired. Authorized returns are clearly marked on the outside of the package with an RA number and the package is shipped freight/postage pre-paid. Consumer returns that do not meet these standards will be refused.

PRODUCT REGISTRATION



Scan the QR code or visit currentbackyard.com to register your product, double your warranty and learn tips and tricks to maintain your CURRENT Pizza Oven.

CAUTION: The user is cautioned that changes or modifications not expressly approved by the party responsible for compliance could void the user's authority to operate the equipment.

This device complies with Part 15 of the FCC Rules. Operation is subject to the following two conditions: (1) this device may not cause harmful interference, and (2) this device must accept any interference received, including interference that may cause undesired operation.

NOTE: This equipment has been tested and found to comply with the limits for a Class B digital device, pursuant to Part 15 of the FCC Rules. These limits are designed to provide reasonable protection against harmful interference in a residential installation. This equipment generates, uses and can radiate radio frequency energy and, if not installed and used in accordance with the instructions, may cause harmful interference to radio communications. However, there is no guarantee that interference will not occur in a particular installation. If this equipment does cause harmful interference to radio or television reception, which can be determined by turning the equipment off and on, the user is encouraged to try to correct the interference by one or more of the following measures:

- Reorient or relocate the receiving antenna.
- Increase the separation between the equipment and receiver.
- Connect the equipment into an outlet on a circuit different from that to which the receiver is connected.
- Consult the dealer or an experienced radio/TV technician for help.

FCC Radiation Exposure Statement

This equipment complies with FCC radiation exposure limits set forth for an uncontrolled environment. This equipment should be installed and operated with a minimum distance of 20cm between the radiator and your body. This transmitter must not be co-located or operating in conjunction with any other antenna or transmitter.







© 2024 CURRENT, LLC. COLUMBUS, GA, 31904-4432

Printed in China

The product associated with this guide was manufactured in China

PN: 80033034 • 01.02.2025